

A4

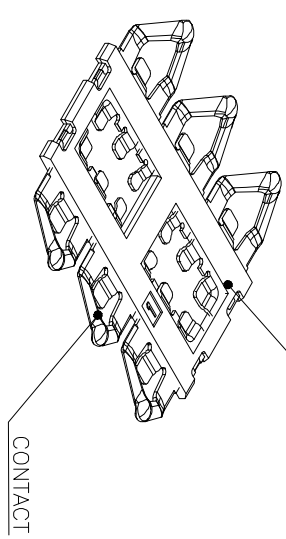

3D VIEW

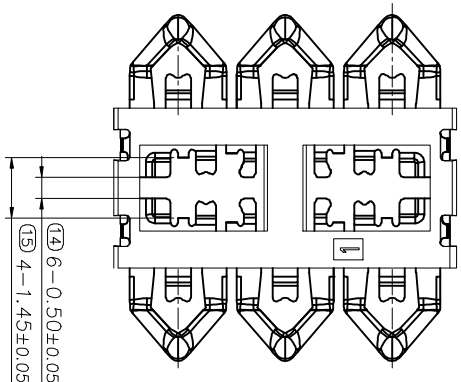
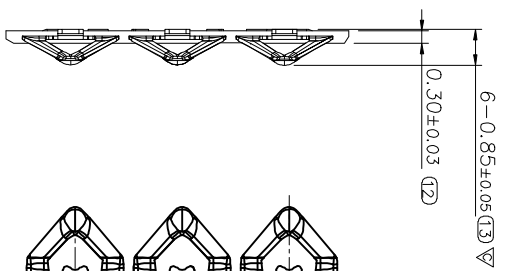
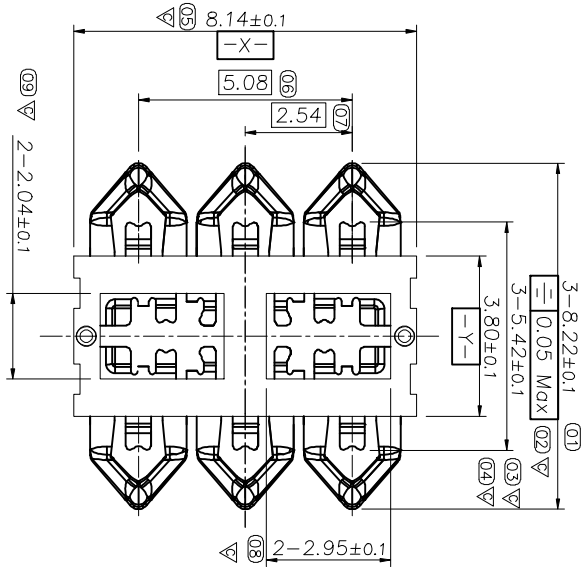
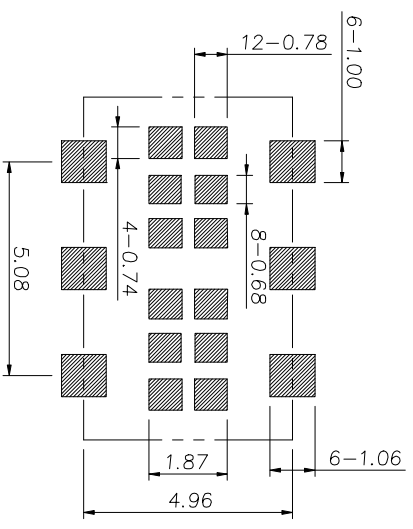
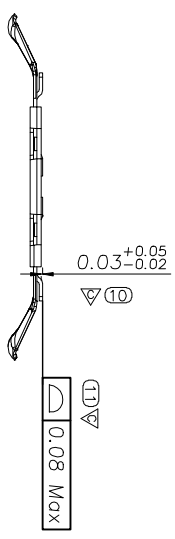

RECOMMENDED PCB LAYOUT
(TOLERANCE +/-0.05)

REV	ECN NO	DESCRIPTION	DATE	APPD
X1		NEW	2017.03.08	Liuhong Tan
X2		贴片电阻改值	2017.09.15	Liuhong Tan
X3		增加产品中间防散孔	2017.12.05	许志远

说明:

NOTE:

- 1. 塑胶材料: LCP, COLOR: BLACK;**
HOUSING MATERIAL: LCP, COLOR: BLACK;
端子材料: 磷青铜, 镀层90U"MIN, 接触区镀金15u", 焊锡区镀金2u";
CONTACT MATERIAL: PHOSPHOR BRONZE;
NICKEL 80U"MIN UNDER PLATED OVER ALL;
15U" MIN. GOLD PLATED AT CONTACT AREA;
2U"MIN GOLD PLATED AT PLATED AT SOLDER TAIL AREA;
- 2. 产品性能:**
PERFORMANCE:
2.1. 耐电压: 使用交流电压500V, 电流1mA, 保持1分钟;
Applied AC 500V for 1 minute 1mA
2.2. 接触阻抗: 50mΩ Max;
CONTACT RESISTANCE: 60mOHM Max.
2.3. 绝缘阻抗: 100MΩ Min.
INSULATION RESISTANCE: 1000MOMH Min.
2.4. 正向力: 最小每PIN 40gf;
NORMAL FORCE: 40gf MIN./PIN
2.5. 插接耐久性: 5000次
DURABILITY : 5000 CYCLES
- 3. 标有 ∇ 的为重点尺寸; 标有 (*) 的尺寸为FAL需测量之尺寸;**
MARK ∇ THE KEY SIZE, MARK (*) FAL.

EXTEND USE		TITLE		DWG NO	
0.3H SIM CARD	UNIT mm	0.3H SIM CARD	APPD	C-1.070A0	FAL
GENERAL TOLERANCE (0)		MATERIAL		P/N:	
DIMENSION	ANGLES ±3°	QTY	CHD	1.070A0-006-SR0	
.0 ±0.25	0 ±2'		DRN	SHEET SCALE	
.00 ±0.20	.00 ±1'	FINISHED	许志远 2017.12.05	1/1	1:1
.000 ±0.10				REV	X3